



An aerial photograph of a proposed development site. The site is bounded by a green line, likely a property boundary. Inside the boundary, there are several buildings: a large, dark grey rectangular building in the center, a smaller grey building to its left, and a larger grey building to its right. There are also some smaller, lighter-colored structures. The surrounding area is mostly green, indicating grass or trees. A road or path runs along the bottom edge of the site. A small yellow car is visible on the road. The image is a top-down view, showing the layout of the buildings and the surrounding landscape.

An aerial photograph of a residential property. The main house is a large, light-colored structure with a complex roofline, including a prominent chimney and a large gabled section. A paved driveway leads from the bottom left towards the house. The property is surrounded by green grass and trees. A small, dark-colored car is parked on the driveway. The overall scene is captured from a high angle, showing the layout of the house and its immediate surroundings.

FSR:GF
1:200

Garage 1: A: 36.00 m²

Garage 2: A: 18.81 m²

DP2:GF
A: 70.72 m²

DP1:GF
A: 56.03 m²

Site: 297.16M² / FSR:0.5:1
GFA ALLOWED: 148.58M²
GFA: 70.72+76.05=146.77 M²

Site: 261.87M² / FSR:0.5:1
GFA ALLOWED: 130.93M²
GFA: 56.03+73.32=129.35 M²

Dimensions: 15,900, 14,380

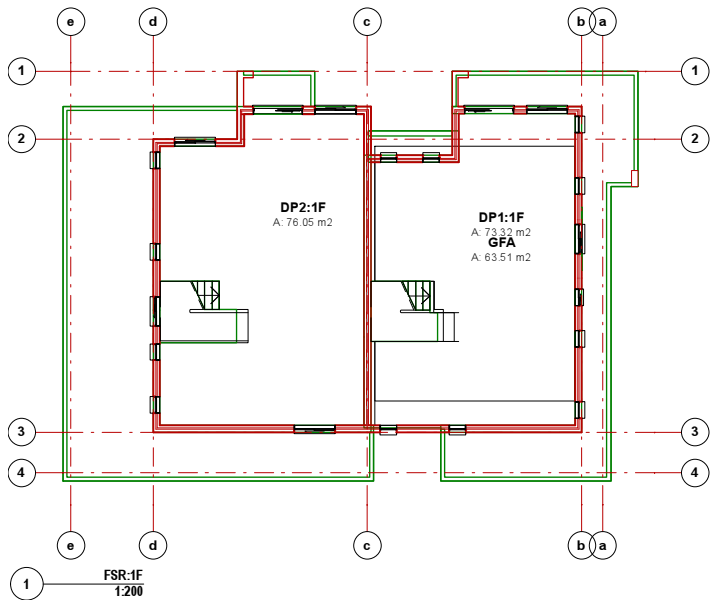
[illegible]